

MAINE CENTRAL
ENGINE HOUSE
AT
BANGOR, MAINE

NOVEMBER, 1974

Scale - 1" = 40'

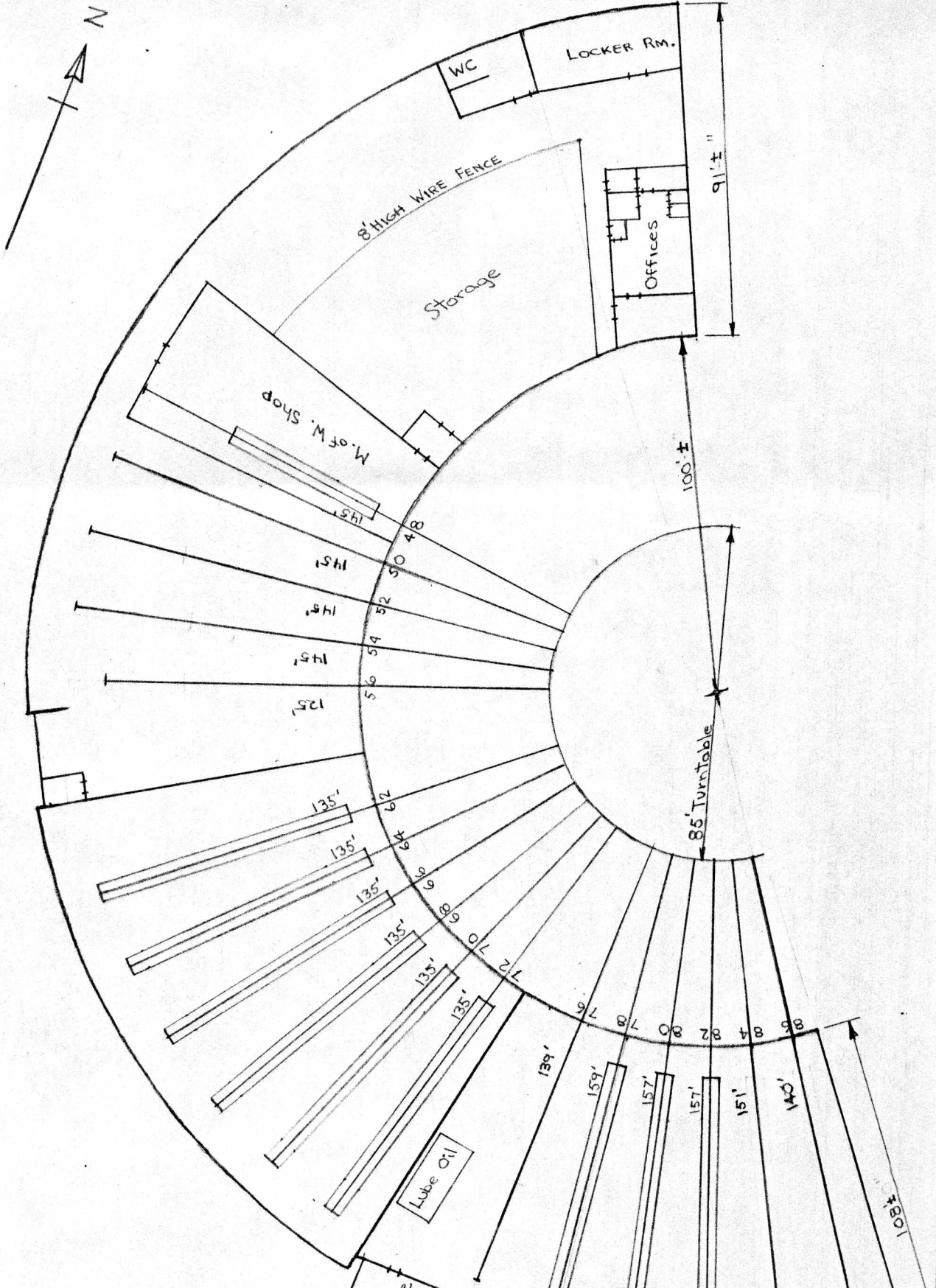

MAINE CENTRAL RAILROAD
ENGINE HOUSE
AT
BEECHER FALLS

NOVEMBER, 1974

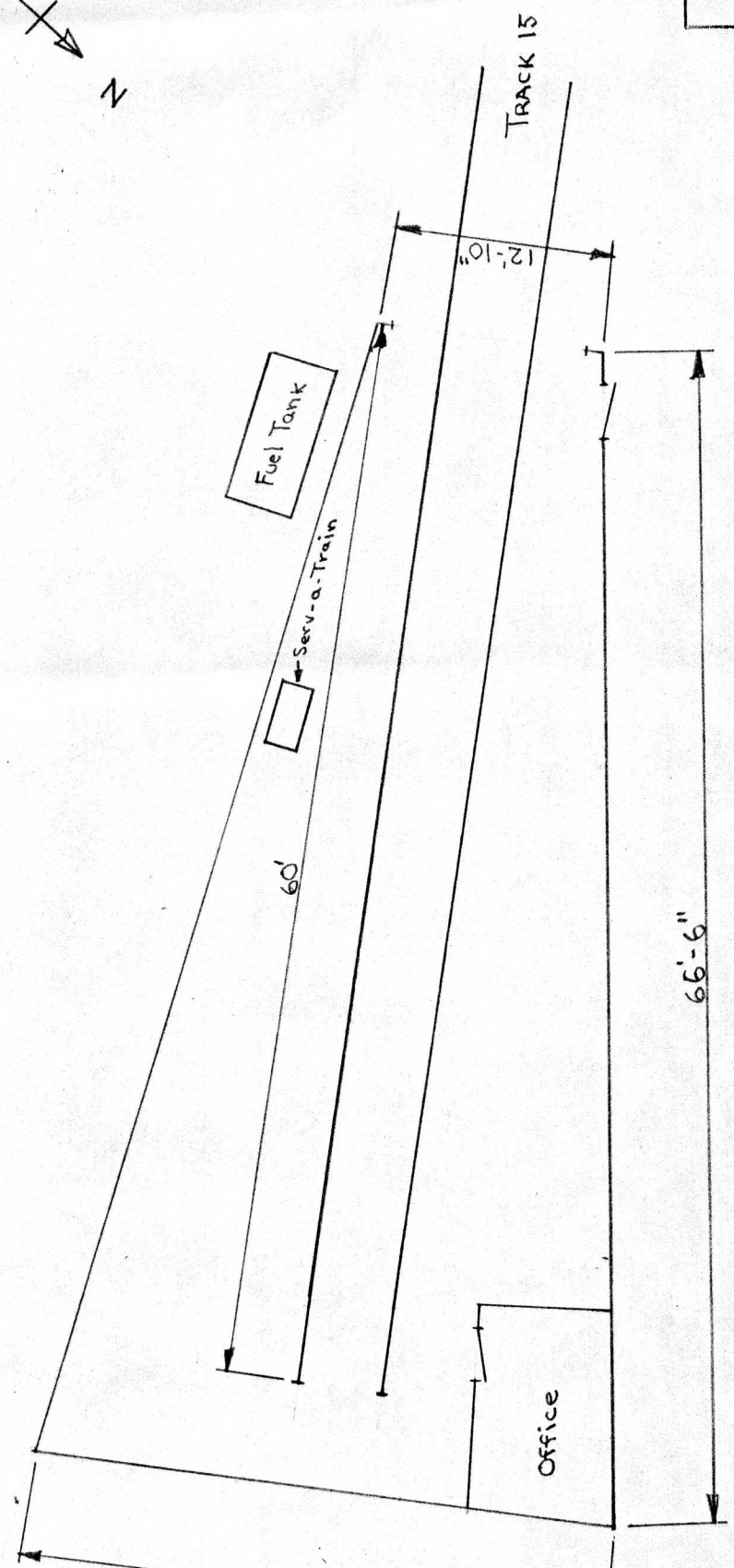
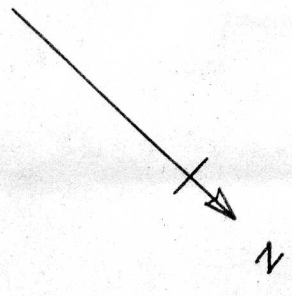

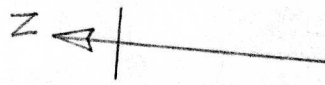
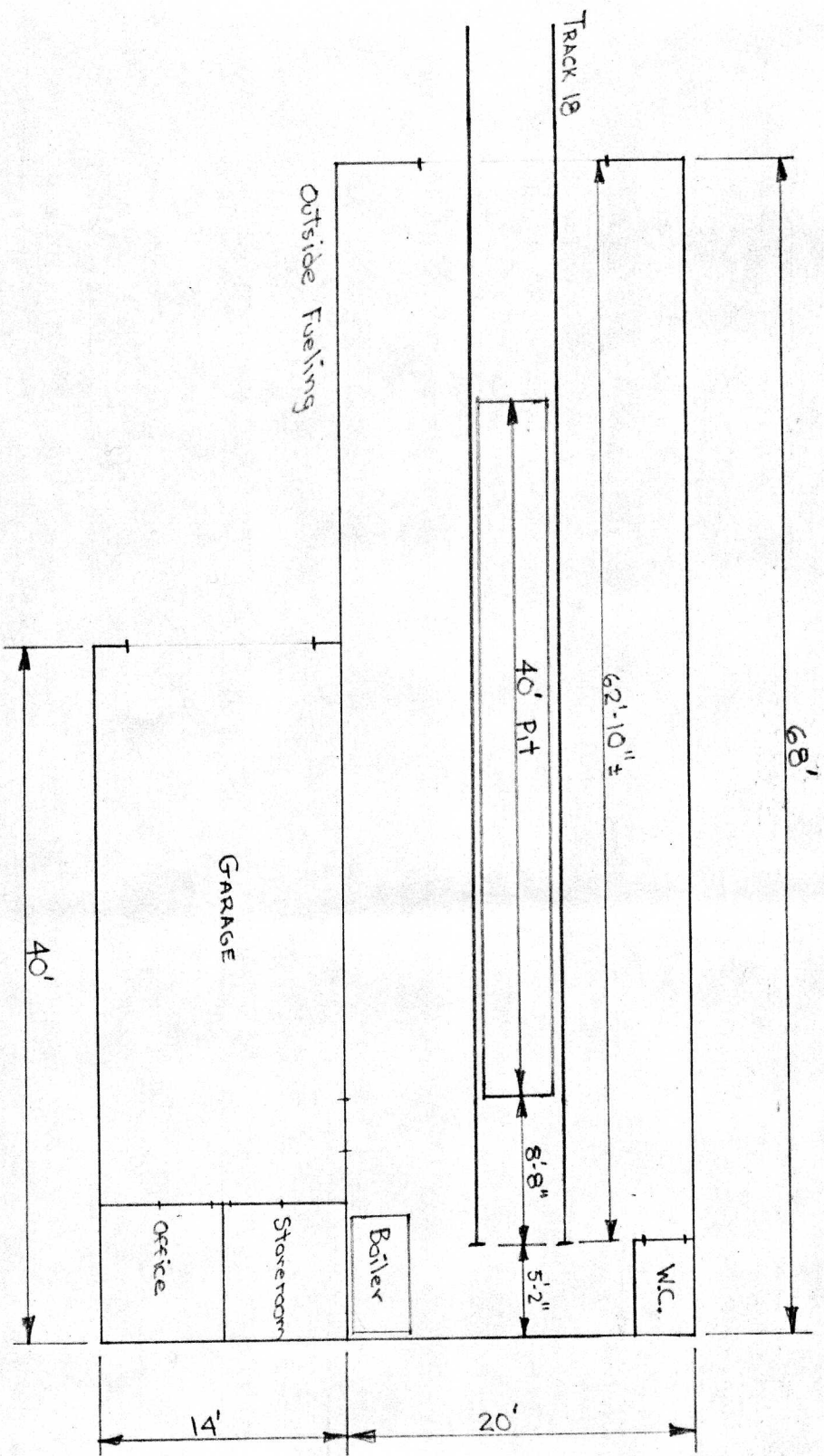

Scale - 1" = 10'-0"

MAINE CENTRE

ENGINE

AT

CALAIS, 1

NOVEMBER, 1974

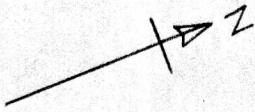

105'

Track 21

49'-6" Pit

14'-0"

MAINE CENTRAL
ENGINE HOUSE
AT
DOVER FOXCROFT

NOVEMBER, 1974

Scale - 1" = 10'

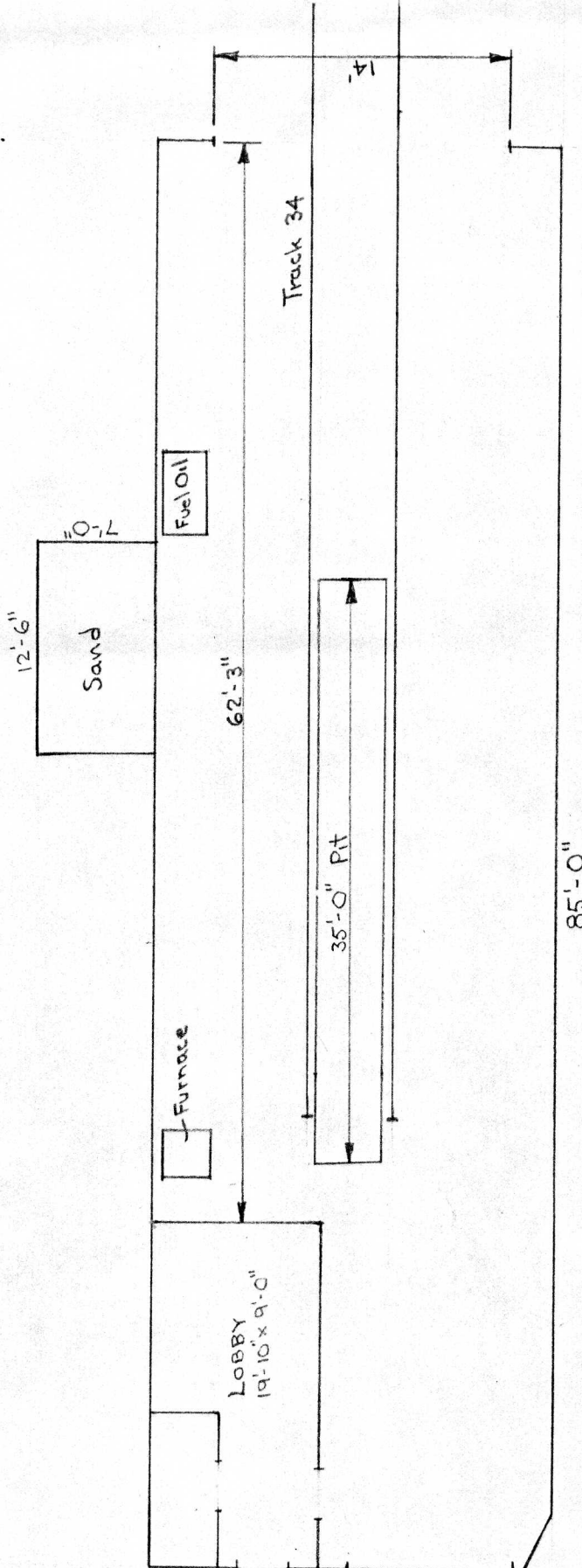
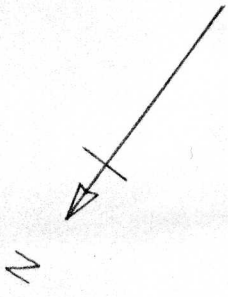

MAINE CENTRAL
ENGINE HO
AT
LEWISTON LOW
NOVEMBER, 1974

SCALE - 1" = 10'

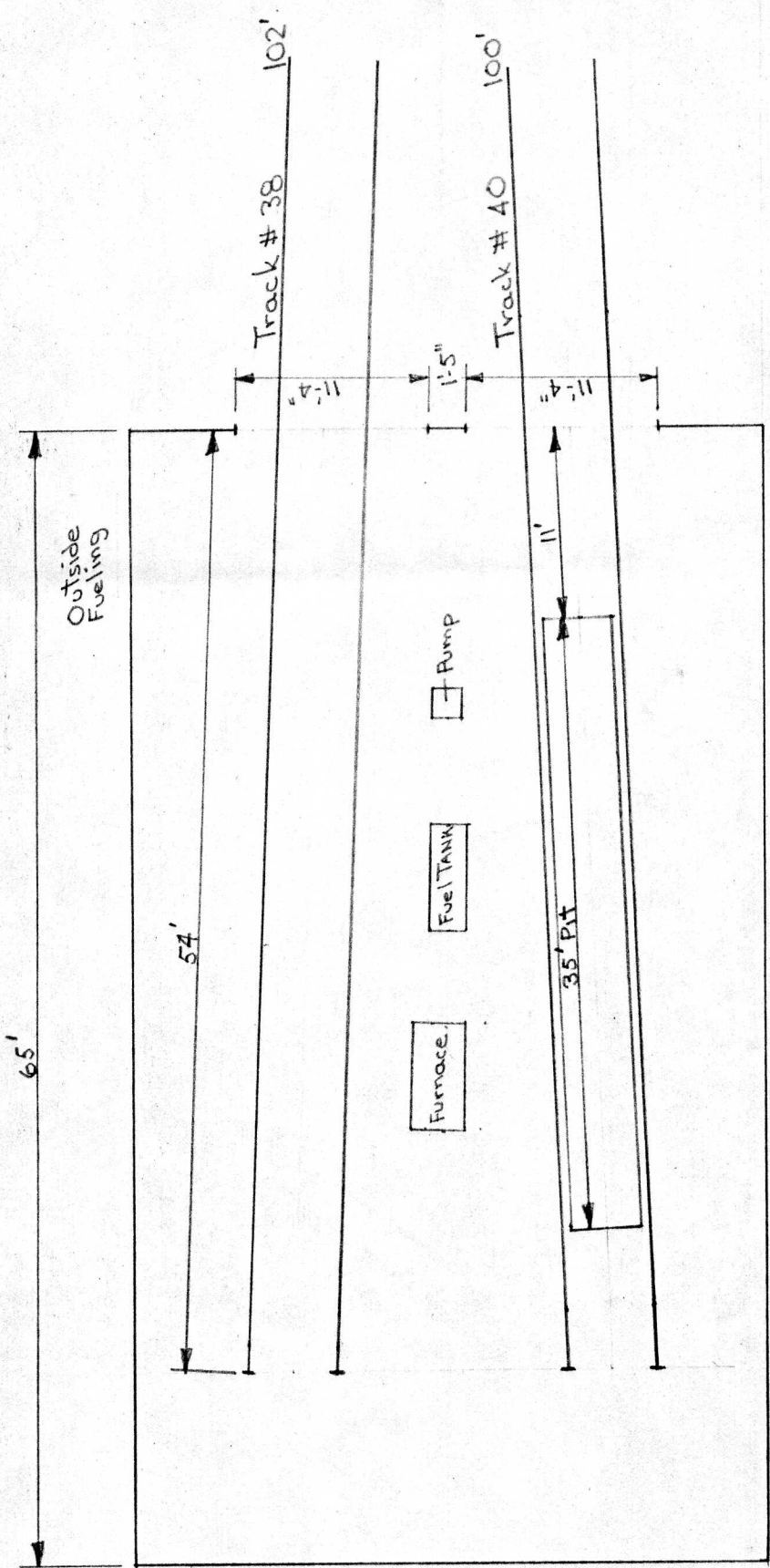

MAINE CENTRAL
ENGINE HOUSE
AT
LIVERMORE
NOVEMBER, 1974

Scale - 1" = 10'-0"

MAINE CENTRAL
ENGINE HOUSE
AT
RIGBY YARD

NOVEMBER, 1974

Scale - 1" = 40'

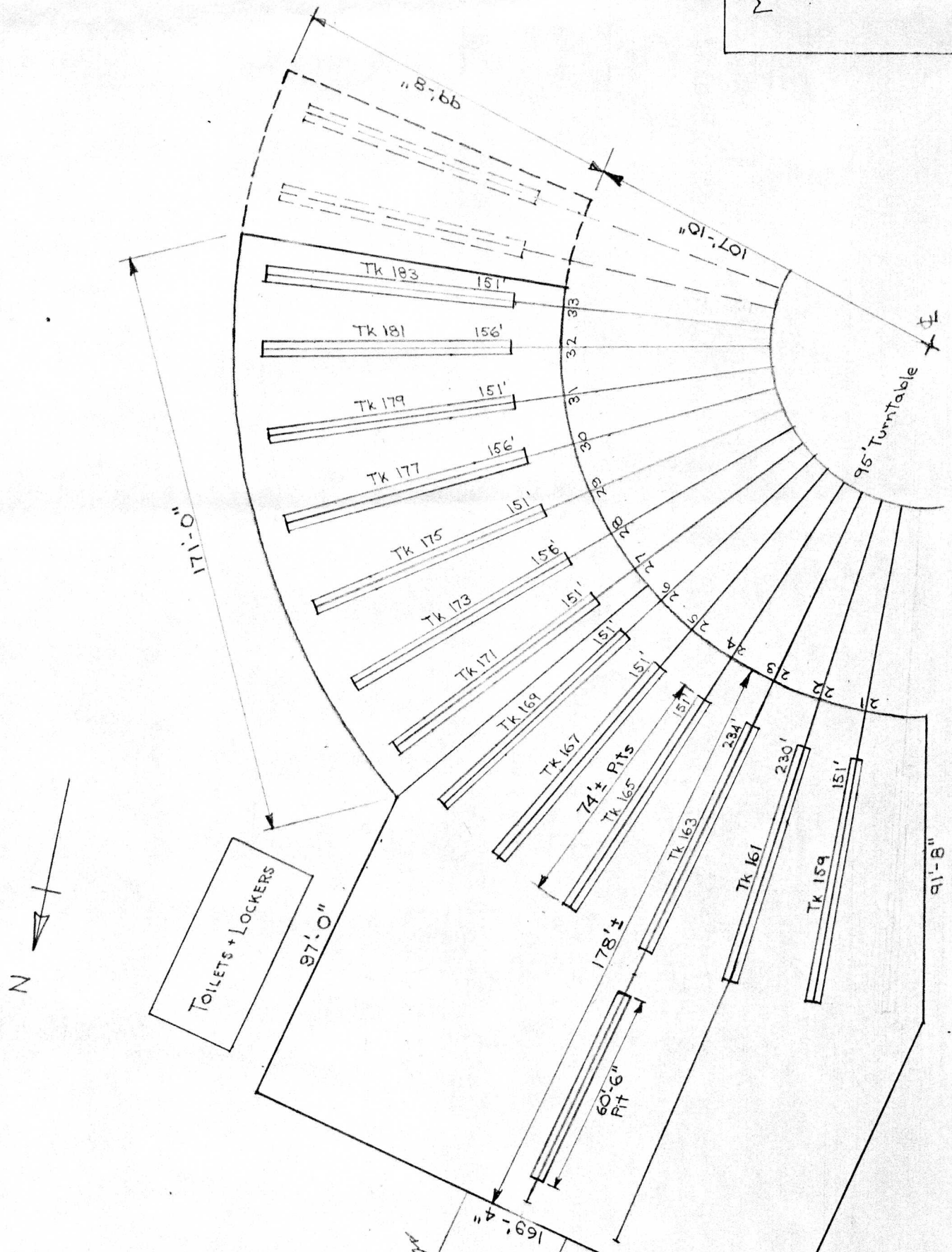

MAINE CENTRAL
 ENGINE HOUSE
 AT
 ROCKLAND, M

NOVEMBER, 1974

Scale - 1" = 20'

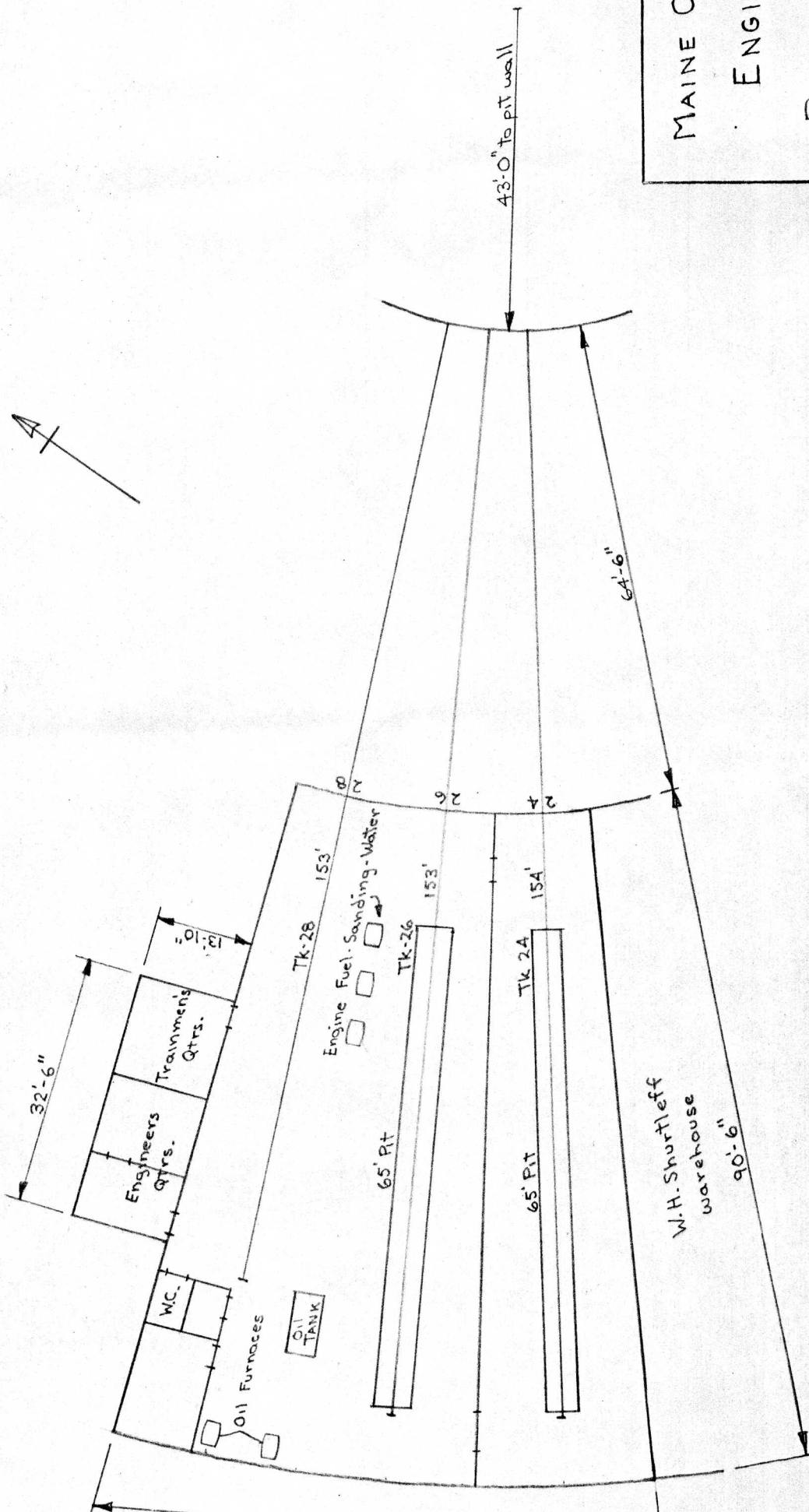
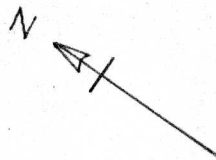

43'-0" to pit wall

64'-6"

W.H. Shurtleff
 warehouse
 90'-6"

MAINE CENTRAL
ENGINE HOUSE
AT
RUMFORD,

NOVEMBER, 1974

Scale - 1" = 20'

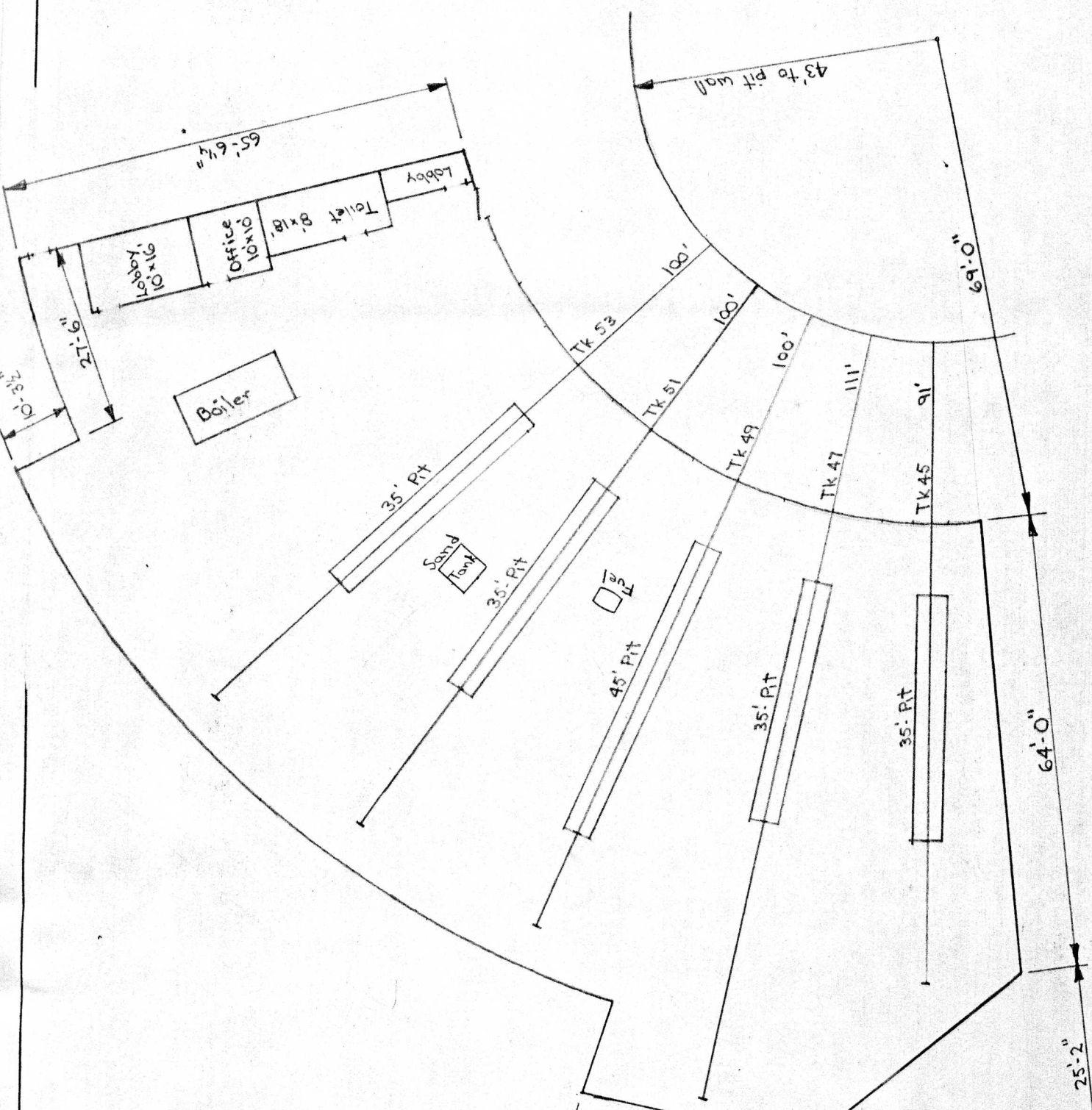
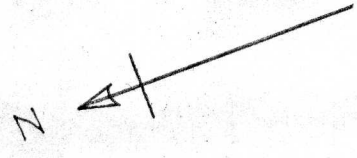

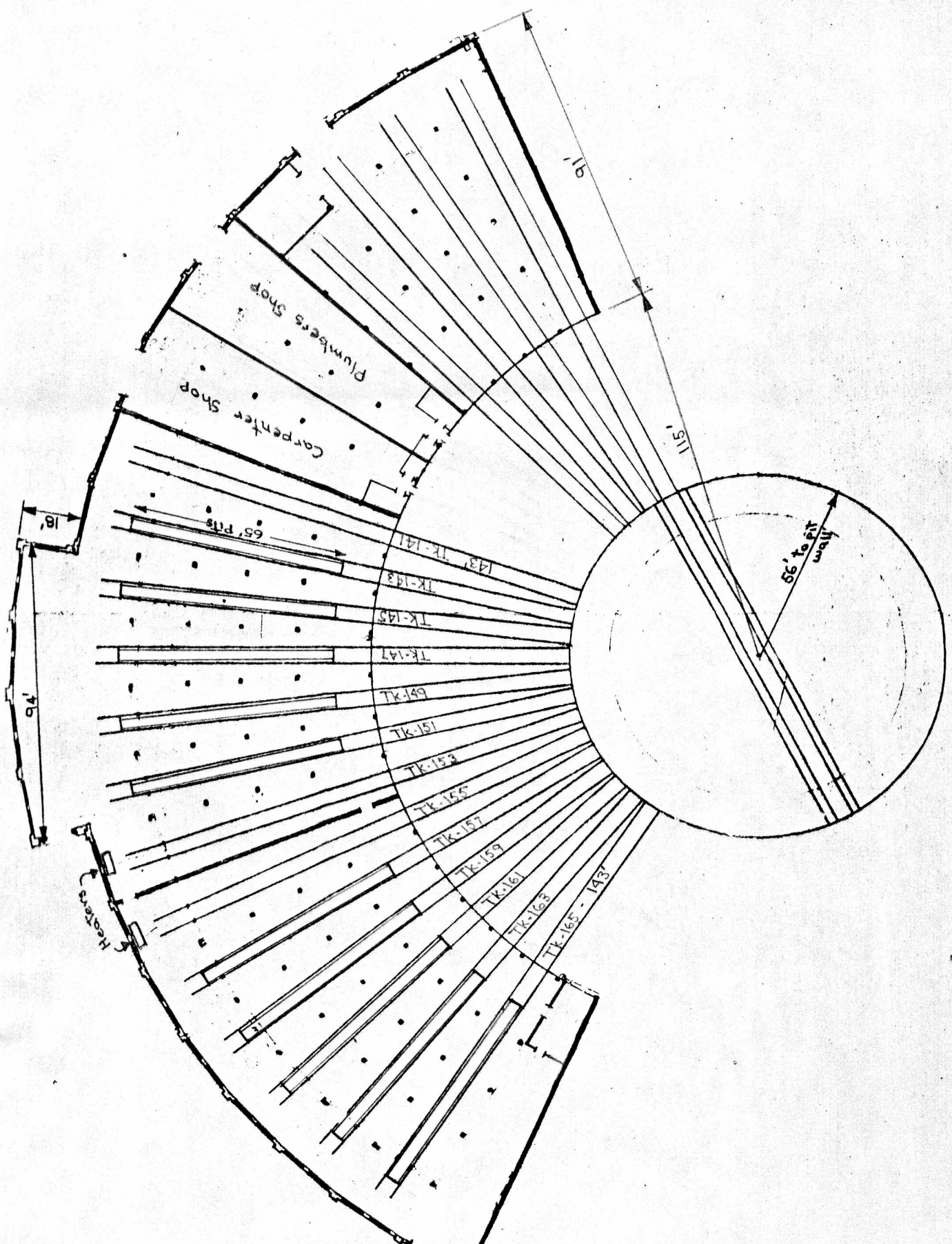

ENGINE HOUSE
Kind & Stalls

TURNTABLE

Location	Kind & Stalls	Length	Capacity	Type	Power	Maximum Turntable Capacities - Diesel Locomotives
Highby	Brick (13)	95 ft.	350 T	3 Point	Electric (Gas Eng. Auxiliary Power)	All single units, all double units, except DS 4 +
Langor	Brick (17)	85 "	300 T	3 "	"	All single units and double units of DS 4 +
Atteterville	Brick (14)	110 "	350 T	3 "	Electric	All single units, all double units except DS 4 +
Akland		70	177½ T	Balanced	Air	All single units
Rockland	Wood (3)	85	275 T	"	Electric	All single units and double units of DS 4 +
Langham		85	275 T	"	Air	All single units and double units of DS 4 +
Newiston Lower	" (1)	85	275 T	"	Electric	All single units and double units of DS 4 +
Sumford	" (5)	80	--	"	"	" " " " " " " "
St. Johnsbury		55	125 T	"	Hand	All single units except DRS 4
Seecher Falls	Wood (1)	65	177½ T	"	"	All single units
Sevejoys		60	170 T	"	"	All single unit switchers no DRS
Silvermore Falls	Brick (2)	75	170 T	"	Air	All single units
Lower-Foxcroft	Wood (1)	85	275 T	"	"	All single units and double units of DS 4 +
Attawamkeag		85	177½ T	"	Electric & Air	" " " " " " " "
Seanceboro	Wood (4)	80	177½ T	"	Electric	" " " " " " " "
Calais	Metal (1)	60	170 T	"	Hand	All single units
Eastport		80	177½ T	"	Electric	All single units and double units of DS 4 +

This statement shows maximum turntable capacities and should not be construed as permitting the operation of locomotives in the territories served by the turntables.

ISSUE
4-6-72
1-1-73

MAINE CENTRAL RAILROAD COMPANY - PORTLAND TERMINAL COMPANY

DIESEL FUEL OIL

<u>Location</u>		<u>Storage</u>
Bangor		500,000 Gals.
Beecher Falls		15,000 " - Serv-A-Train
Calais		15,000 Gals. "
Lewiston Upper		2,000 Gals.
" Lower		2,000 "
Livermore Falls		2,000 "
Rockland		15,000 " Serv-A-Train
Rumford		12,000 Gals.
Vanceboro		27,200 " (1 - 11,897 Gals.)
Waterville		30,000 " (1 - 15,248 ")
Portland-Rigby (PT Co.)		420,000 " (3 - 10,000 ")
" -Yard 8 " "		16,000 "

ISSUE

1-1-69

7c

1-1-71

1-1-72

1-1-73

MAINE CENTRAL RAILROAD COMPANY - PORTLAND TERMINAL COMPANY

WATER STATIONS FOR DIESEL LOCOMOTIVES

Station	Location	Supply	Remarks
Bangor	Engine House	2"	
Beecher Falls	" "	1"	Murdock Hyd. in Engine House
Calais	" "	2"	
Lewiston Lower	" "	2" w 3/4" hose conn.	Murdock Hydrant in Engine House
Lewiston Upper	End of Tk. #30	3/4"	Murdock Hyd. in Diesel Fuel Pump House
Livermore Falls	Engine House	3/4"	
Mattawamkeag	Pass Station	2 1/2"	Electric
Rockland	Engine House	2"	Murdock Hydrant
Rumford	Engine House	2"	Murdock Hyd. & Hose
St. Johnsbury		1 1/2" CP	
Vanceboro	" "	2"	M.C.R.R. Well
Waterville	" "	2"	Hose, Murdock Hydrant
Portland (PT Co.) Rigby, Yard 13		1 1/2"	Hose connections located at Diesel Pit (Two)
Portland (PT Co.) Rigby, Engine House		2"	Hose connections (Two) Three